

NEW ARCH

btgroup.it

Lesmo (MB)	T. +39 039 62 84 81	info@btgroup.it
Bari	T. +39 080 53 78 817	btsud@btgroup.it
Santa Fè, Granada (España)	T. +34 958 04 10 15	info@btgroup.es



Questo catalogo è stato stampato con inchiostri a base vegetale.  
This catalogue was printed with vegetable-based inks.

PROJECT  
**CODE**



ITALIAN OUTDOOR

CUSTOM  
OUTDOOR  
DESIGN  
EXPERIENCE





CODE  
IS A  
NEW ARCH  
PROJECT

## CODE

L'innovativo e rivoluzionario sistema a doghe in alluminio si integra perfettamente con diverse soluzioni di pergolati, superando l'elemento piantana. CODE rappresenta l'emblema del custom-made: ogni progetto outdoor diventa unico, personale ed esclusivo. CODE supporta e si integra con chiusure perimetrali tuttovetro, tende verticali a cavo o drappeggi.



# CODE

## NEW+ARCH

design: Ivo Pellegrini

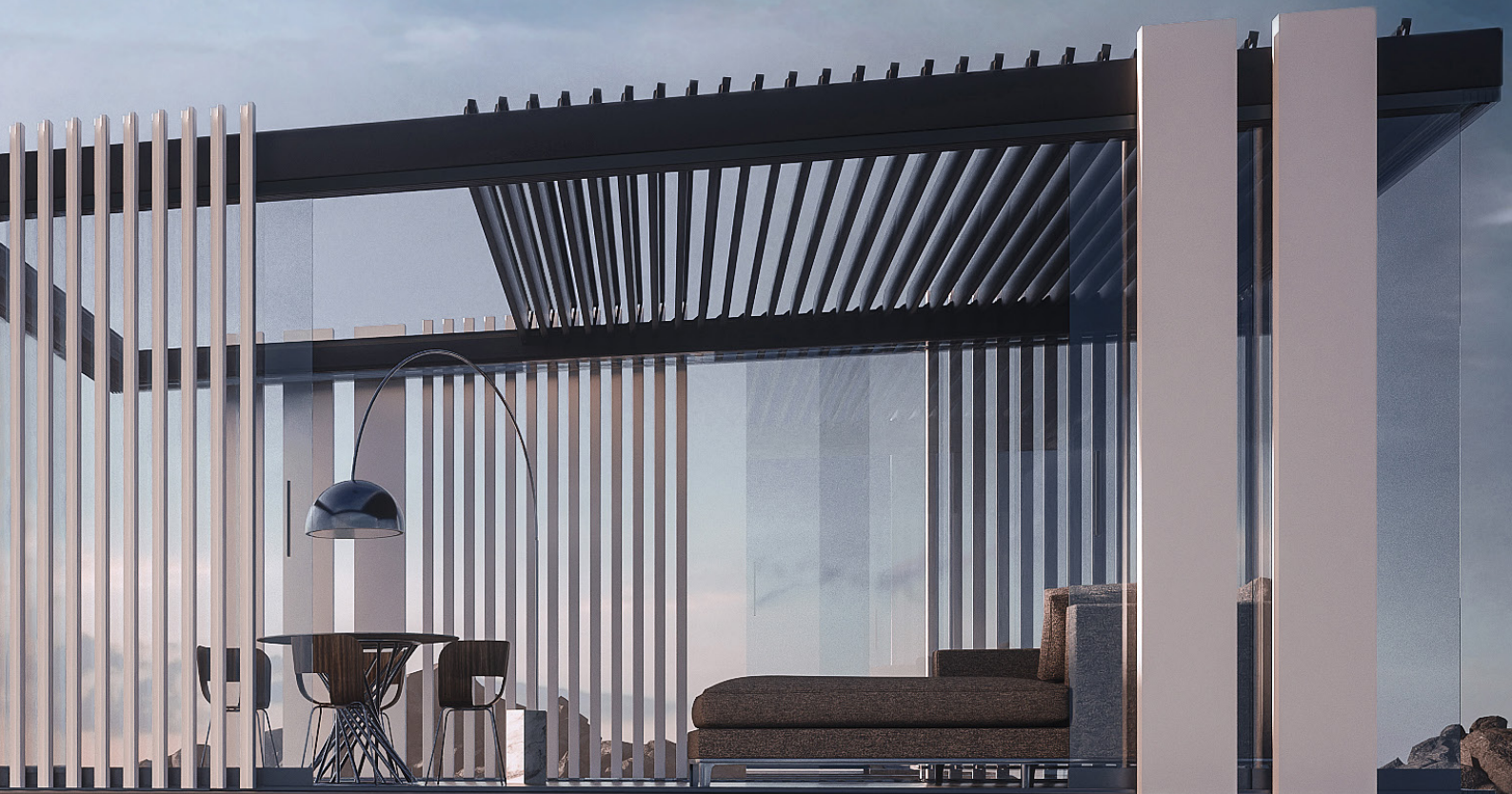

The innovative and revolutionary aluminium slatted system perfectly blends in with various pergola solutions, extending beyond the poles. CODE represents the epitome of custom-made: each outdoor project becomes unique, personal, and exclusive. CODE supports and is compatible with all-glass perimeter closures, vertical awnings with cable guide or draperies.



## CUSTOM

Un prodotto personalizzabile che ascolta e accoglie ogni esigenza, dando forma ai sogni per tradurli in realtà.

**CODE è l'anima che alimenta la propria casa, l'io interiore che trova la sua massima espressione, l'identità che nasce dall'essenza stessa degli spazi. Lo penso, lo desidero, lo voglio.**

A customisable product that listens to and accommodates every need, shaping dreams into reality.

CODE is the soul that fills the home, the inner self that finds its highest expression, the identity that springs from the very essence of spaces.  
I think it, I wish it, I want it.

# OUTDOOR

Lo sguardo di CODE è rivolto al futuro, verso un design di outdoor sostenibile che esalta il paesaggio e l'ambiente.

Verso l'armonia tra uomo e natura.  
Lo progetto, lo costruisco e lo vivo nel rispetto di ciò che mi circonda.

CODE looks to the future, towards sustainable outdoor design that enhances the landscape and environment.

Towards harmony between man and nature.  
I design it, I build it, and I live it with respect for my surroundings.





CODE

NEW+ARCH

## DESIGN

La pergola CODE è espressione di un'architettura essenziale e moderna che eleva il design a forma d'arte.

Un'interpretazione contemporanea ma senza tempo, che sfugge dagli schemi per inseguire la libertà.

L'armonia di vuoti e pieni, i materiali innovativi e il design inimitabile rendono CODE un prodotto unico nel suo genere.

The CODE pergola is an expression of understated and modern architecture that elevates design to an art form.

A contemporary yet timeless interpretation that breaks the mould in pursuit of freedom.

The harmony of full and empty spaces, innovative materials and inimitable design, makes CODE a product unique to its kind.

# CODE

NEW+ARCH

## EXPERIENCE

**Un nuovo luogo da vivere, da ascoltare,  
un sogno in cui perdersi per poi ritrovarsi,  
un flusso piacevolmente incontrollato di sensazioni.**

**Un'esplorazione dentro se stessi.  
Un tuffo dentro nuovi mondi possibili.**

A new place to live, to listen, a dream in which to lose and then find oneself again, a flow of pleasantly uncontrolled feelings.

An exploration of one's inner self.  
A dive into new possible worlds.





## GLASSES

I confini tra interno ed esterno vengono superati, gli spazi fusi insieme, le atmosfere e i comfort si uniscono, creando un ambiente ibrido, astratto, libero.

Le vetrate scorrevoli invitano la luce naturale ad entrare, ma allo stesso tempo isolano e proteggono.

The boundaries between indoors and outdoors are overcome, spaces are combined, atmospheres and comforts are fused, creating a hybrid, abstract, free environment.

The sliding glass doors invite the natural light in, but at the same time insulate and protect.



# PRIVACY

La pergola vede, ma non si fa vedere.

Le lamelle verticali di CODE consentono di godere appieno del panorama circostante, senza rinunciare alla privacy del proprio spazio abitativo.

Ogni soluzione viene personalizzata, limitando o espandendo la visibilità dall'interno e dall'esterno, per vivere la propria intimità come si vuole, quando si vuole.

The pergola sees, but never reveals itself.

CODE's vertical louvres allow full enjoyment of the surrounding landscape without sacrificing the privacy of your living space.

Every solution is customised, either limiting or expanding visibility from the inside and outside, to experience intimacy just the way you want, when you want.



CARATTERISTICHE TECNICHE

TECHNICAL CHARACTERISTICS

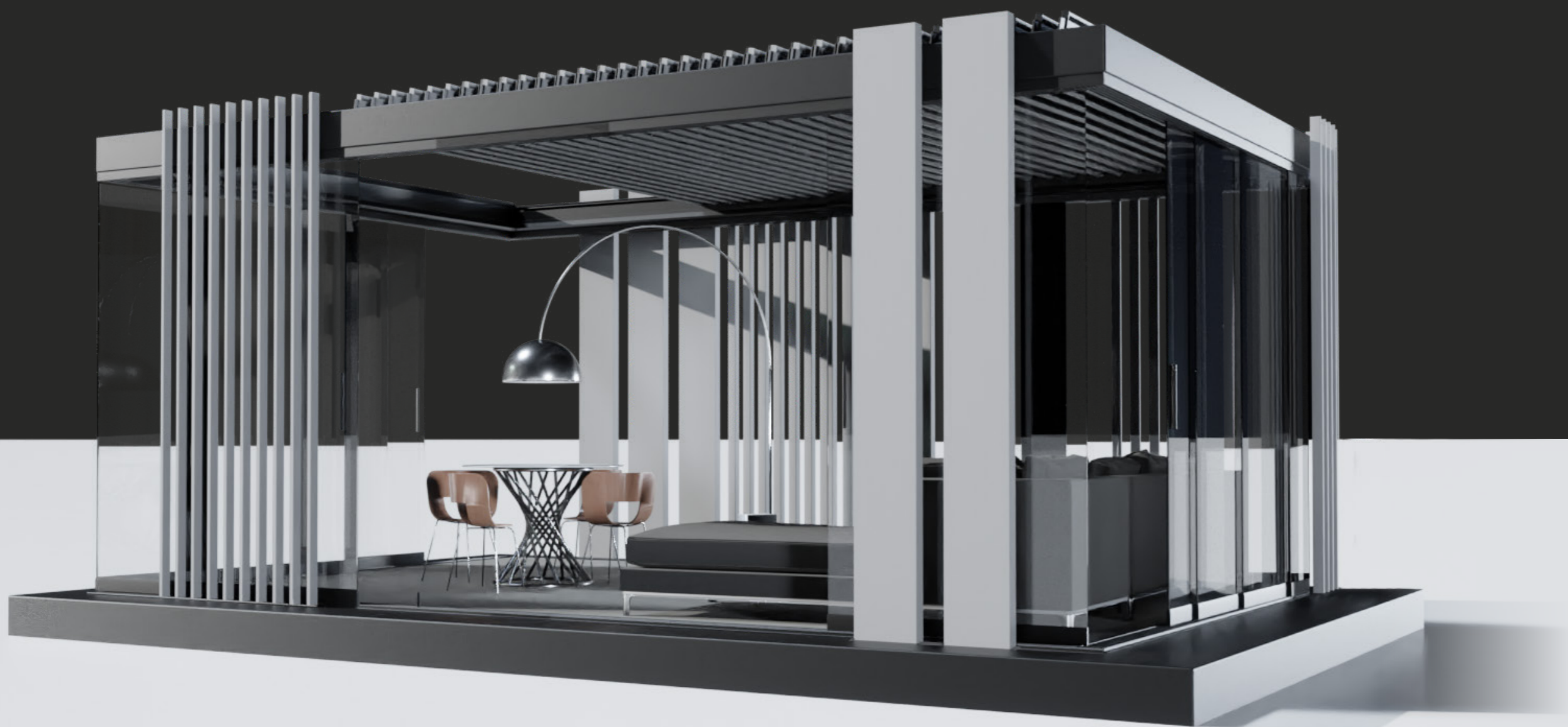

# DATI TECNICI

# TECHNICAL DATA

Quote espresse in mm | Dimensions in mm

## VERSIONE SLANCIATA | SLENDER VERSION

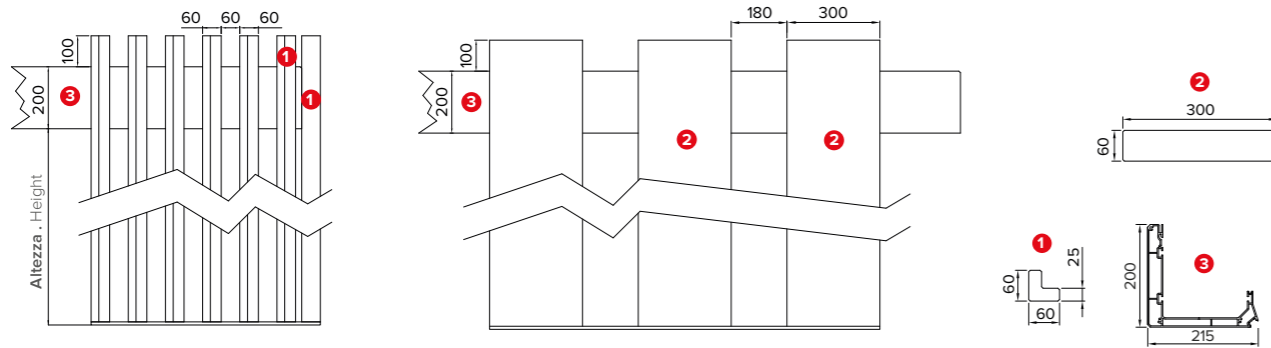

## VERSIONE FILO STRUTTURA | ALIGNED WITH THE STRUCTURE

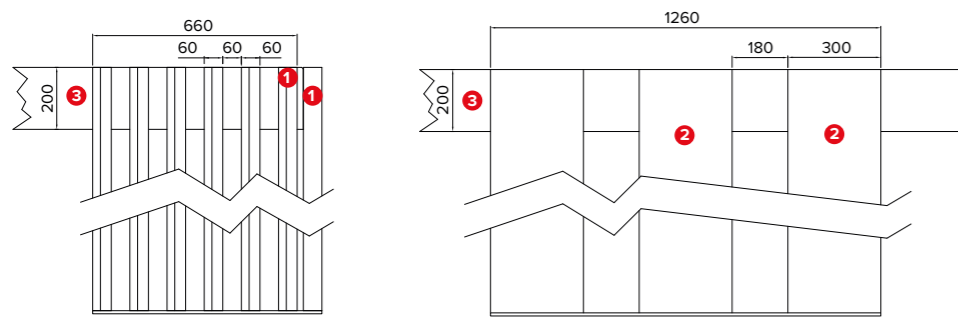

## SCARICO ACQUA INTEGRATO | INTEGRATED WATER DRAIN

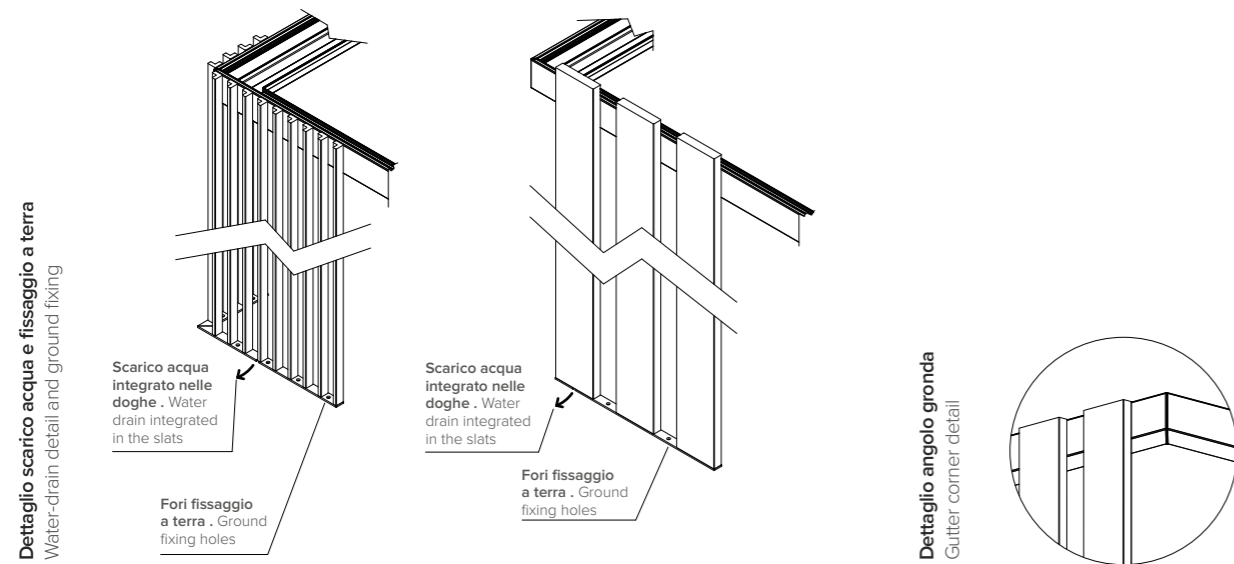

### LEGENDA TECNICA TECHNICAL LEGEND

- 1 Doga 60x60 mm . Slat 60x60 mm
- 2 Doga 300x60 mm . Slat 300x60 mm
- 3 Gronda 20x21,5 cm . Gutter 20x21,5 cm

# ESEMPI DI CONFIGURAZIONE

# EXAMPLES OF CONFIGURATION

## VISTA DALL'ALTO | TOP VIEW

**VARIANTE 1 | VARIANT 1**  
12 doghe 60x60 mm  
12 slats 60x60 mm

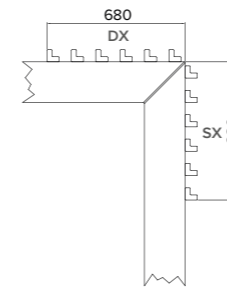

**VARIANTE 2 | VARIANT 2**  
12 doghe 60x60 mm  
12 slats 60x60 mm

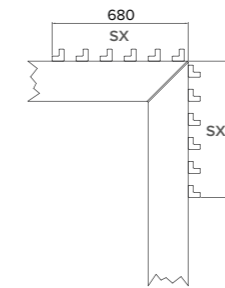

**VARIANTE 3 | VARIANT 3**  
13 doghe 60x60 mm  
13 slats 60x60 mm

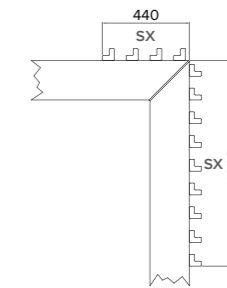

**VARIANTE 4 | VARIANT 4**  
11 doghe 60x60 mm  
11 slats 60x60 mm

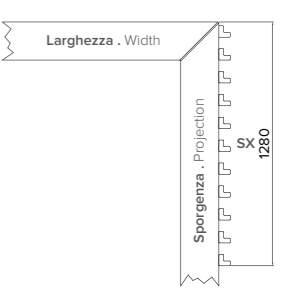

**VARIANTE 5 | VARIANT 5**  
3 doghe 300x60 mm  
3 slats 300x60 mm

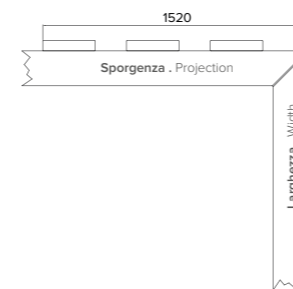

**VARIANTE 6 | VARIANT 6**  
8 doghe 60x60 mm  
2 doghe 300x60 mm  
8 slats 60x60 mm  
2 slats 300x60 mm

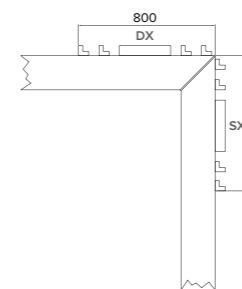

**VARIANTE 7 | VARIANT 7**  
6 doghe 300x60 mm  
6 slats 300x60 mm

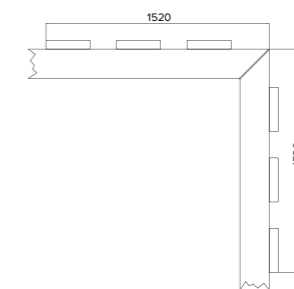

**VARIANTE 8 | VARIANT 8**  
3 doghe 300x60 mm  
3 slats 300x60 mm

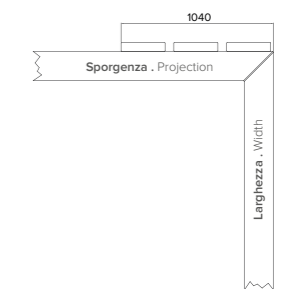

## ESEMPI DI REALIZZAZIONE | EXAMPLES OF REALIZATION

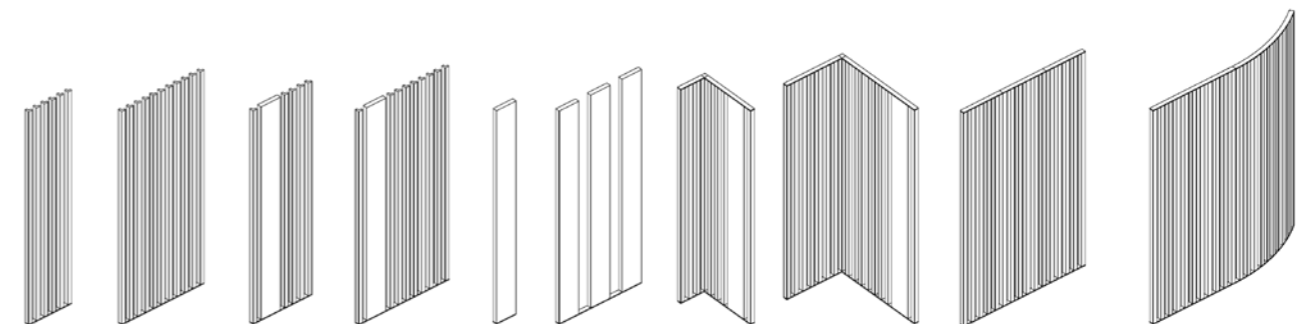

**NOTA BENE:** la distanza tra un gruppo doghe e l'altro non può mai superare i 6mt. di campata.  
Possibilità di altre varianti a disegno, previa fattibilità ufficio tecnico.  
**PLEASE NOTE:** the distance between two groups of slats can never be more than 6m.  
Possibility of other variations according to drawing, subject to approval by technical office.

# PERSONALIZZAZIONE

## CUSTOMIZATION

### CLIMATICHE COMPATIBILI | COMPATIBLE CANOPIES

 Disponibili in 62 colori  
Available in 62 colors

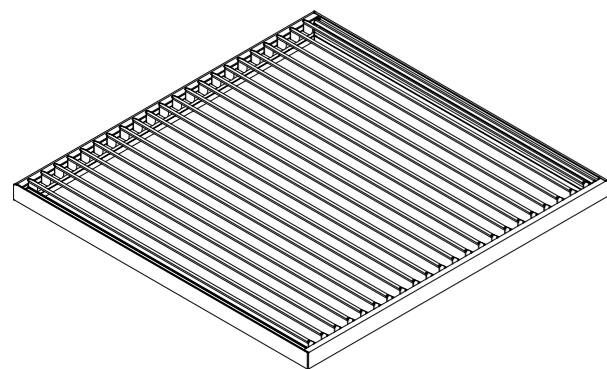

PERGOKLIMA

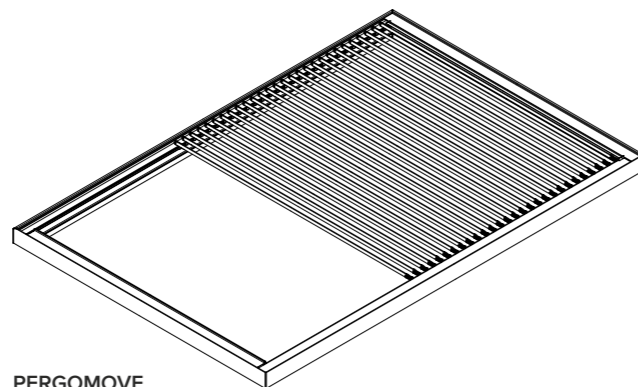

PERGOMOVE

**i** Disponibili ulteriori modelli in PVC / Tetto fisso  
Other PVC models / fixed roof available

### DOGHE | SLATS

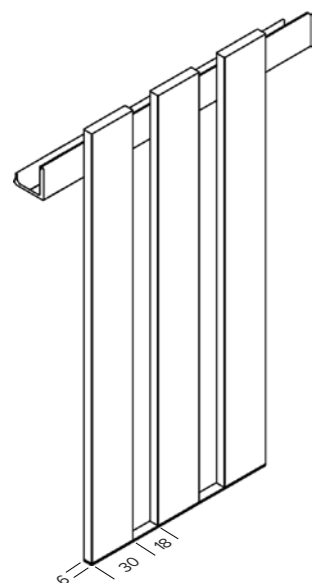

Dimensioni 30x6 cm - Spazio 18 cm  
Size 30x6 cm - Gap 18 cm

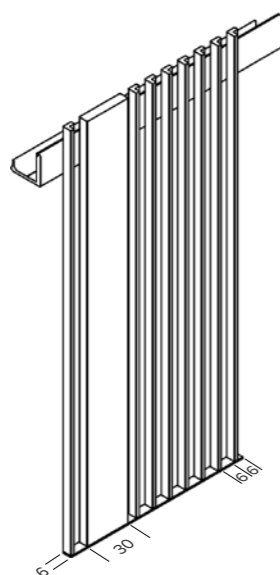

Dimensioni 6x6 cm / 30x6 cm - Spazio 6 cm  
Size 6x6 cm / 30x6 cm - Gap 6 cm

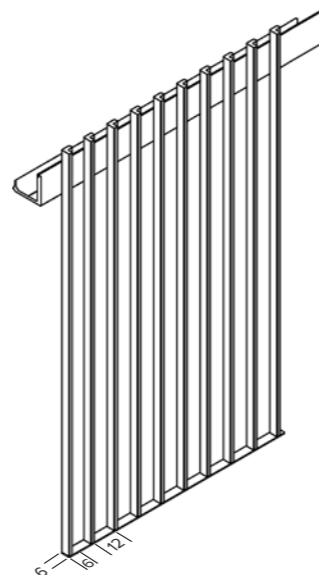

Dimensioni 6x6 cm - Spazio 12 cm  
Size 30x6 cm / 6x6 cm - Gap 12 cm

**i** Questa soluzione è consigliata in  
presenza di sistema TUTTOVETRO.  
This solution is recommended in  
presences of ALL-GLASS system.

 Disponibili in 62 colori  
Available in 62 colors

# PERSONALIZZAZIONE

## CUSTOMIZATION

### PANNELLI IN CEMENTO CONCRETE PANELS

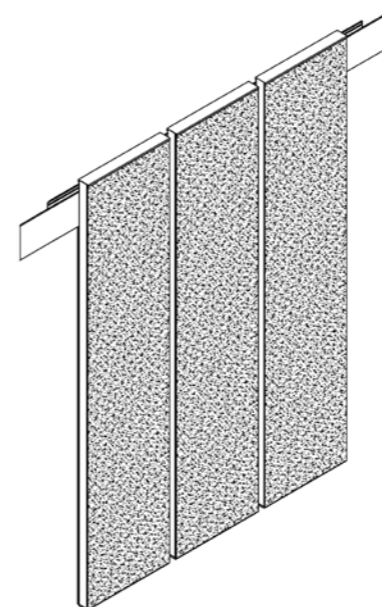

### PANNELLI IN VETRO GLASS PANELS

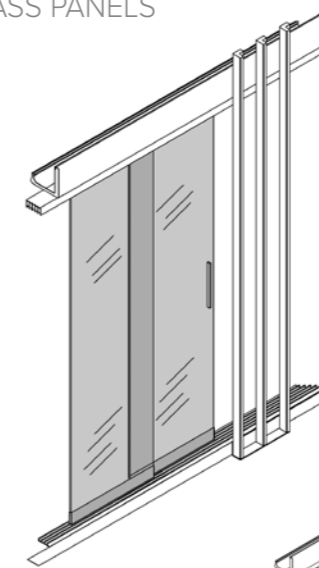

### TENDE A DRAPPEGGIO DRAPERY CURTAINS



### FARETTI | SPOTLIGHTS

Due possibilità di installazione  
Two installation possibilities

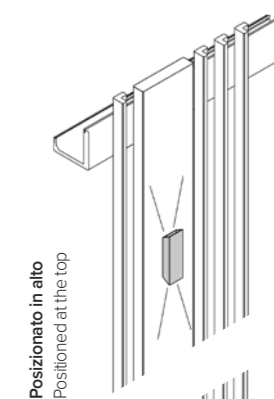

Posizionato in alto  
Positioned at the top

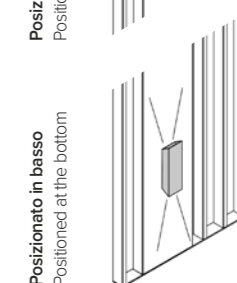

Posizionato in basso  
Positioned at the bottom

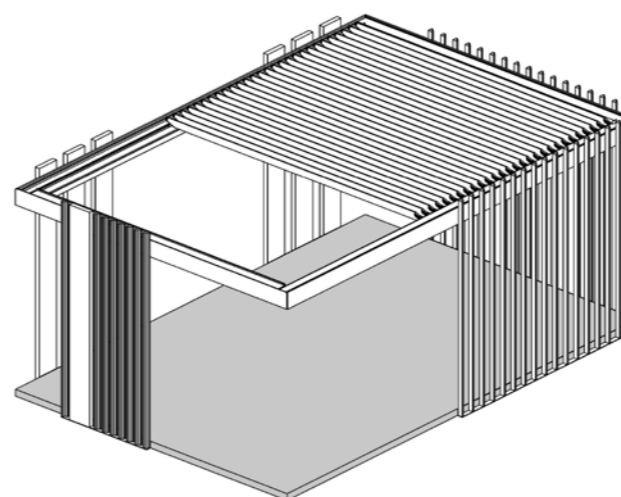

CODE CON PEDANA | CODE WITH PLATFORM

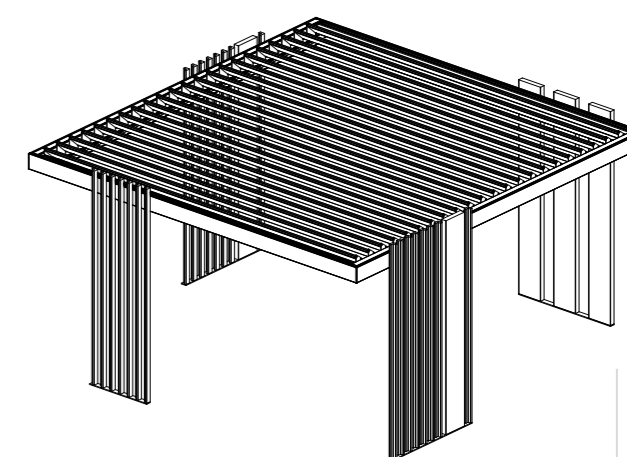

CODE SENZA PEDANA | CODE WITHOUT PLATFORM

PENISOLA | WALL MOUNTING

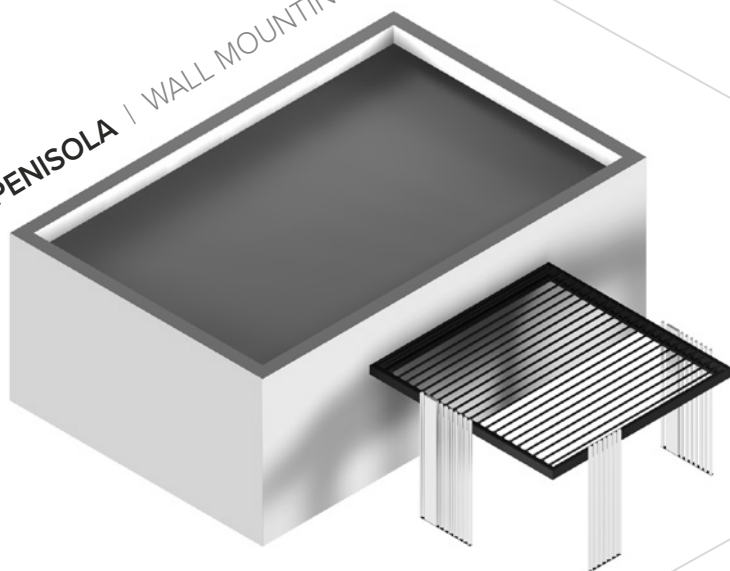

AUTOPORTANTE | SELF STANDING

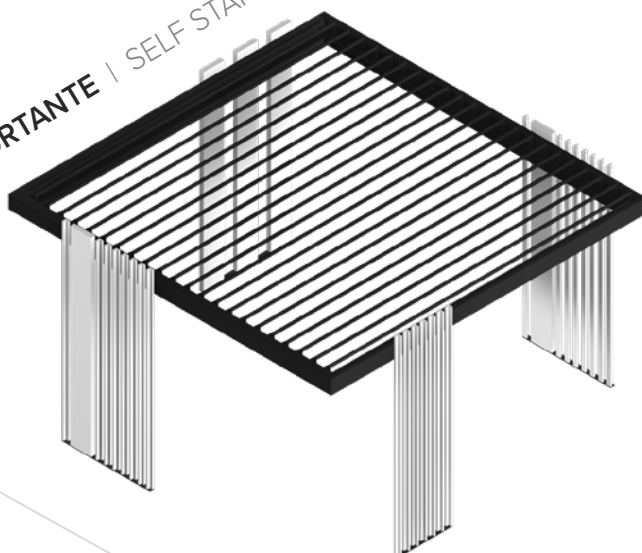

INTEGRATA | INTEGRATED

